

Project: Neighborly Welcome

INSPIRED BY "HOMETOWN PARADE" FROM DESIGNER AVIS SHIRER OF JOINED AT THE HIP



These deep, warm tones are from Jo's Jamestown collection by Jo Morton for Andover Fabrics.

## Project: Neighborly Welcome

A neighborhood of nine rectangular blocks makes this almost-square throw.

### Materials

- $\frac{1}{3}$  yard total assorted orange prints (Log Cabin blocks)
- 8" square dark red print (blocks)
- $\frac{1}{3}$  yard total assorted olive green prints (Log Cabin blocks)
- $\frac{1}{3}$  yard total assorted navy and slate blue prints (Log Cabin blocks)
- $\frac{1}{3}$  yard total assorted brown prints (Log Cabin blocks)
- $\frac{1}{2}$  yard tan stripe (house blocks, inner border)
- $\frac{1}{8}$  yard each of brown print and black print (roofs of house blocks)
- $\frac{1}{3}$  yard each of blue stripe and brown stripe (house blocks)
- $\frac{1}{8}$  yard olive green plaid (house blocks)
- 8" square orange plaid (house blocks)
- $1\frac{1}{8}$  yards brown stripe (outer border, binding)
- $2\frac{1}{2}$  yards backing fabric
- 50x56" batting

Finished quilt:  $43\frac{1}{2} \times 49\frac{1}{2}$ "

Finished blocks:  $11 \times 13$ "

Quantities are for 44/45"-wide, 100% cotton fabrics.

Measurements include  $\frac{1}{4}$ " seam allowances. Sew with right sides together unless otherwise stated.

### Cut Fabrics

Cut pieces in the following order.

#### From assorted orange prints, cut:

- $5-1\frac{1}{2} \times 11\frac{1}{2}$ " strips
- $5-1\frac{1}{2} \times 9\frac{1}{2}$ " strips
- $5-1\frac{1}{2} \times 7\frac{1}{2}$ " strips
- $5-1\frac{1}{2} \times 5\frac{1}{2}$ " strips
- $5-1\frac{1}{2} \times 3\frac{1}{2}$ " strips
- $5-1\frac{1}{2}$ " squares

#### From dark red print, cut:

- $13-1\frac{1}{2}$ " squares

#### From assorted olive green prints, cut:

- $5-1\frac{1}{2} \times 11\frac{1}{2}$ " strips
- $5-1\frac{1}{2} \times 9\frac{1}{2}$ " strips
- $5-1\frac{1}{2} \times 7\frac{1}{2}$ " strips
- $5-1\frac{1}{2} \times 5\frac{1}{2}$ " strips
- $5-1\frac{1}{2} \times 3\frac{1}{2}$ " strips
- $5-1\frac{1}{2}$ " squares

#### From assorted navy and slate blue prints, cut:

- $5-1\frac{1}{2} \times 11\frac{1}{2}$ " strips
- $5-1\frac{1}{2} \times 9\frac{1}{2}$ " strips
- $5-1\frac{1}{2} \times 7\frac{1}{2}$ " strips
- $5-1\frac{1}{2} \times 5\frac{1}{2}$ " strips
- $5-1\frac{1}{2} \times 3\frac{1}{2}$ " strips

#### From assorted brown prints, cut:

- $5-1\frac{1}{2} \times 11\frac{1}{2}$ " strips
- $5-1\frac{1}{2} \times 9\frac{1}{2}$ " strips
- $5-1\frac{1}{2} \times 7\frac{1}{2}$ " strips
- $5-1\frac{1}{2} \times 5\frac{1}{2}$ " strips
- $5-1\frac{1}{2} \times 3\frac{1}{2}$ " strips

#### From tan stripe, cut:

- $4-1\frac{1}{2} \times 42$ " strips for inner border
- $4-1\frac{1}{2} \times 5\frac{1}{2}$ " strips
- $8-2\frac{1}{2}$ " squares
- $8-1\frac{1}{2} \times 2\frac{1}{2}$ " rectangles

#### From brown print, cut:

- $2-2\frac{1}{2} \times 11\frac{1}{2}$ " strips

#### From black print, cut:

- $2-2\frac{1}{2} \times 11\frac{1}{2}$ " strips

#### From blue stripe, cut:

- $2-2\frac{1}{2} \times 11\frac{1}{2}$ " strips
- $2-1\frac{1}{2} \times 11\frac{1}{2}$ " strips
- $16-2\frac{1}{2} \times 3\frac{1}{2}$ " rectangles
- $2-1\frac{1}{2} \times 5\frac{1}{2}$ " strips

#### From brown stripe, cut:

- $2-2\frac{1}{2} \times 11\frac{1}{2}$ " strips
- $2-1\frac{1}{2} \times 11\frac{1}{2}$ " strips
- $16-2\frac{1}{2} \times 3\frac{1}{2}$ " rectangles
- $2-1\frac{1}{2} \times 5\frac{1}{2}$ " strips

#### From olive green plaid, cut:

- $20-1\frac{1}{2} \times 3\frac{1}{2}$ " strips

#### From orange plaid, cut:

- $4-1\frac{1}{2} \times 4\frac{1}{2}$ " strips

#### From brown stripe, cut:

- $5-4\frac{1}{2} \times 42$ " strips for outer border
- $5-2\frac{1}{2} \times 42$ " binding strips

### Assemble Log Cabin Blocks

1. Sew together an orange print  $1\frac{1}{2}$ " square, dark red print  $1\frac{1}{2}$ " square, and olive green print  $1\frac{1}{2}$ " square in a vertical row to make a block center (Diagram 1). Press seams toward dark red square.
2. Referring to Diagram 2, sew navy or slate blue print and brown print  $1\frac{1}{2} \times 3\frac{1}{2}$ " strips to side edges of block center. Press seams away from block center.
3. Referring to Diagram 3, add orange print and olive green print  $1\frac{1}{2} \times 3\frac{1}{2}$ " strips to top and bottom edges of block center. Press seams away from block center.
4. Referring to Diagram 4, continue adding strips to side edges, then top and bottom edges in Courthouse Steps fashion to make a Log Cabin block. Press all seams away from block center. The block should be  $11\frac{1}{2} \times 13\frac{1}{2}$ " including seam allowances.
5. Repeat steps 1 through 4 to make five Log Cabin blocks total.

## Project: Neighborly Welcome

**Assemble House Blocks**

1. Use a pencil to mark a diagonal line on wrong side of each tan stripe  $2\frac{1}{2}$ " square.
  2. Align a marked tan stripe  $2\frac{1}{2}$ " square with each end of a brown print  $2\frac{1}{2}\times 11\frac{1}{2}$ " strip (Diagram 5; note directions of drawn lines). Stitch on marked lines; trim excess fabric, leaving  $\frac{1}{4}$ " seam allowances. Press open attached triangles to make roof unit.
  3. Referring to Diagram 6, lay out roof unit and tan stripe, dark red print, blue stripe, olive green plaid, and orange plaid pieces for house block in sections. Sew together pieces in each section; press seams toward darker prints.
  4. Join sections to make a blue house block. Press seams in one direction. The block should be  $11\frac{1}{2}\times 13\frac{1}{2}$ " including seam allowances.
  5. Repeat steps 2 through 4 to make a second blue house block.
  6. Substituting black print for brown print and brown stripe for blue stripe, repeat steps 2 through 4 to make two brown house blocks total.
3. Cut and piece tan stripe  $1\frac{1}{2}\times 42$ " strips to make:
    - 2— $1\frac{1}{2}\times 39\frac{1}{2}$ " inner border strips
    - 2— $1\frac{1}{2}\times 35\frac{1}{2}$ " inner border strips
  4. Sew long inner border strips to long edges of quilt center. Add short inner border strips to remaining edges. Press all seams toward border.
  5. Cut and piece brown stripe  $4\frac{1}{2}\times 42$ " strips to make:
    - 2— $4\frac{1}{2}\times 43\frac{1}{2}$ " outer border strips
    - 2— $4\frac{1}{2}\times 41\frac{1}{2}$ " outer border strips
  6. Sew brown stripe  $4\frac{1}{2}\times 41\frac{1}{2}$ " outer border strips to long edges of quilt center. Add brown stripe  $4\frac{1}{2}\times 43\frac{1}{2}$ " outer border strips to remaining edges to complete quilt top. Press all seams toward outer border.

**Finish Quilt**

1. Layer quilt top, batting, and backing; baste. Quilt as desired.
2. Bind with brown stripe binding strips.

**Assemble Quilt Top**

1. Referring to photo on page 1, lay out blocks in three rows. Sew together blocks in each row. Press seams in one direction, alternating direction with each row.
2. Join rows to make quilt center. Press seams in one direction. The quilt center should be  $33\frac{1}{2}\times 39\frac{1}{2}$ " including seam allowances.

## Project: Neighborly Welcome

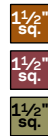

DIAGRAM 1



DIAGRAM 2



DIAGRAM 3

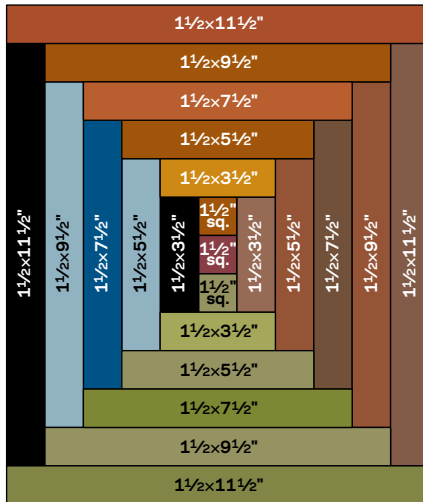

DIAGRAM 4



DIAGRAM 5

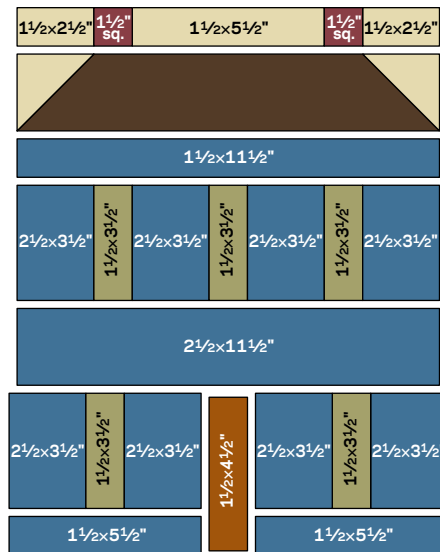

DIAGRAM 6